



3-Digit Combination Luggage Lock

Web Manual

HOW TO SET

The original combination is 0-0-0. To set your own combination:

1. Turn the dials to the correct combination. Keep the shackle closed. Do not press down on the lock button.
2. Use a pen or tool to press down the reset button, and push the button to the up position until it locks into the groove.
3. Set your own combination by turning the dials, and make sure that the numbers on the dial line up with the top and bottom arrows. (e.g. 888)
4. Use the same tool to move the reset button back to the default position (move the reset button to the down position).

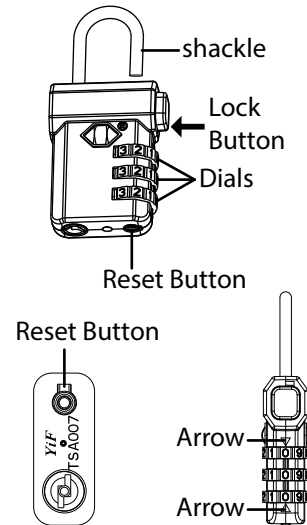

The resetting is now completed. Please write down your new combination and keep it in a safe place.

HOW TO USE

1. Turn the dials to the correct combination, and make sure that the numbers line up with the top and bottom arrows. Press down the lock button to open.
2. Insert the shackle and scramble the numbers to lock.

Indicating Pole Feature

1. The Indicating Pole is originally in the hidden position (Pic. 1)
2. When the TSA inspectors open the lock with their specific access tool, the Indicating Pole will be raised. (Pic 2) Then you can know that your luggage was inspected by the Customs Officers.
3. The Indicating Pole will return to the original hidden position (Pic. 1) when you open the lock with the correct combination.

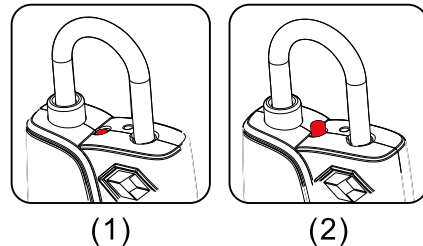

Follow Us On Social Media



www.fosmon.com
support@fosmon.com
© 2019 Fosmon Inc. All rights reserved.



DO NOT RETURN THE PRODUCT

There are good days and there are bad days. It is our BAD if the product is not working, or if you are not happy with it. PLEASE GIVE US A CHANCE and WE WILL MAKE IT RIGHT.

1-833-3-Fosmon (833-336-7666)
(612) 435-7508
support@fosmon.com

Limited Lifetime Warranty

Visit fosmon.com/warranty for Product Registration, warranty and limited liability details.

Recycling the Product

To dispose this product properly, please follow the recycling process regulated in your area.